

NOTICE OF HEARING

Kansas City Missouri

4840 Community Improvement District

NOTICE IS HEREBY GIVEN THAT:

1. A hearing will be held in the City Council Chambers on the 26th floor of City Hall, 414 East 12th Street, in Kansas City, Missouri, at 1:30 P.M. on Wednesday, June 28, 2023, for the purpose of considering the amended petition of the 4840 Community Improvement District (the "District") herein described.
2. A Petition for the amendment of the 4840 Community Improvement District has been filed with the City Clerk of Kansas City, Missouri.
3. The boundaries of the District are shown on the map included with this notice and described in the separate boundary description.
4. A copy of the amended petition is available for review at the office of the City Clerk during regular business hours on the 25th floor of City Hall at 414 East 12th Street, Kansas City, Missouri.
5. All interested persons shall be given an opportunity to be heard at the public hearing.

Dated: June 9, 2023

Marilyn Santiers
City Clerk
Kansas City, Missouri



Legal Description of 4840 Community Improvement District

THE 4840 ROANOKE CONDOMINIUM, a condominium subdivision in the City of Kansas City, Jackson County, Missouri, and that public right of way generally indicated on the map included with the petition to establish the community improvement district and the notice of the public hearing.

Owner
14 West Proprietor, LLC
8000 Shawnee Mission Parkway, Suite 200
Shawnee Mission, KS 66202

Developer
Caymus West Group LLC
4024 Main Street
Kansas City, MO 64112
816.465.4444

Architect
360 Threesidy Architecture
300 W. 23rd Street
Kansas City, MO 64108
816.472.3390

Contractor
J.C. Davis Construction
4025 College Boulevard
Overland Park, KS 66210
816.454.2660

Civil Engineer
SA Design Group, Inc.
4025 College Boulevard
Overland Park, KS 66211
816.451.1318

Structural Engineer
J.C. Davis Construction
13200 Blue Road West
Meriden, MO 63042
866.656.4444

MEP
Henderson Engineering, Inc.
8825 Lenora Drive
Lenora, KS 66214
913.742.5000

Cost Consultant
FSC Inc.
8020 Mission Creek Parkway
Overland Park, KS 66210
913.702.8470

Building Enclosure
Hartman & Associates
145 South Outer Perry Road
Suite 110
Overland Park, MO 66211

Accountant/Consultant
Accountant Design Group
5789 Broadway, Suite 700
Shawnee Mission, KS 66202
913.384.1281

Landscape Architect
Patt Borch Associates
1000 Walnut St., Suite 700
Kansas City, MO 64101
816.431.0000

Door Hardware Consultant
BMA Door Hardware Consulting
4012 Roanoke Parkway
Kansas City, MO 64111
816.851.8217

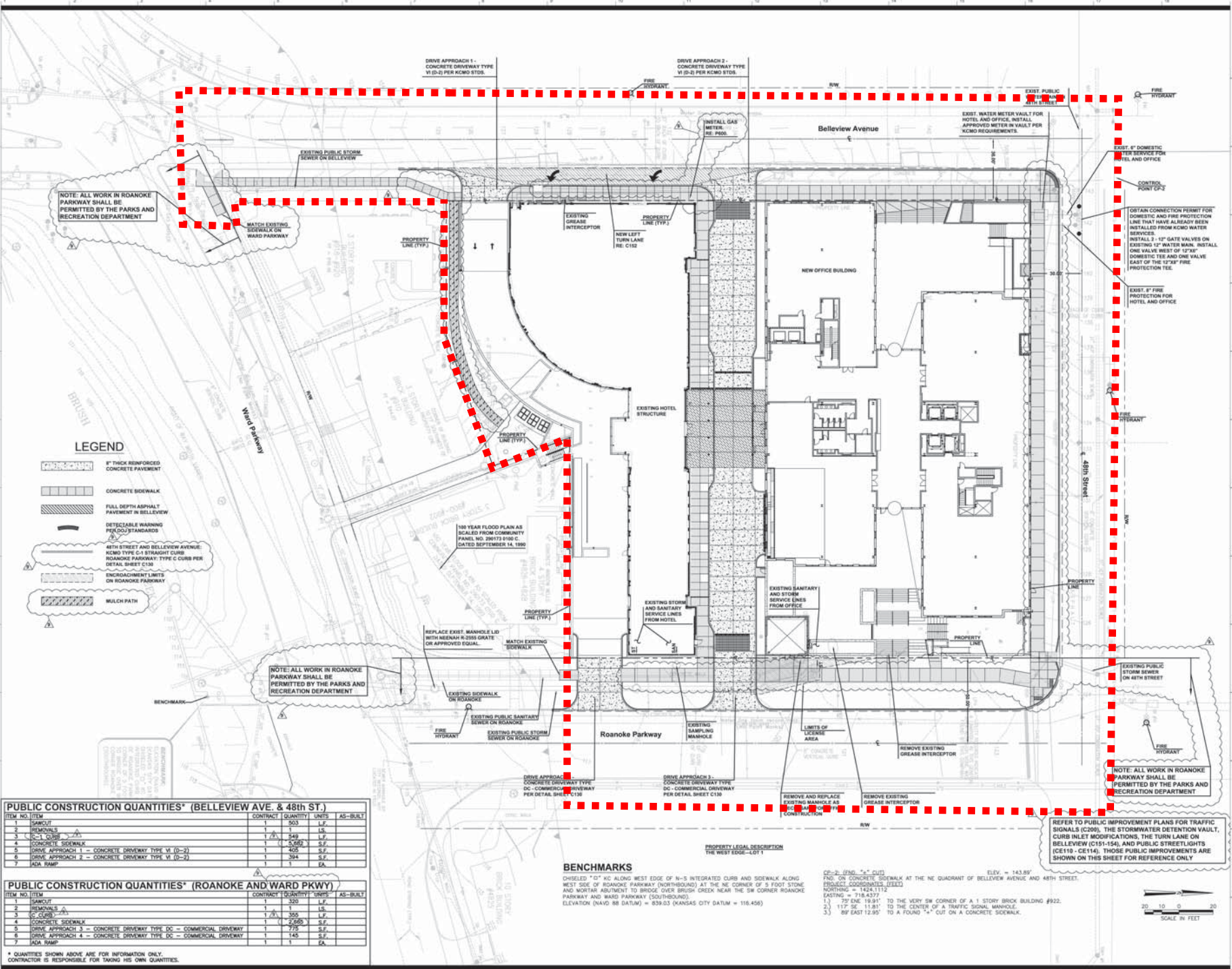

Copyright © 2011, 360 ARCHITECTURE INC.



32912 ADDENDUM #5

Date: 12/30/11
Project: Construction Documents
Issued by: Permit
Project Number: 114800

SITE LAYOUT PLAN

Sheet Number: C110